

## Making an Animated GIF in Photoshop Elements 6

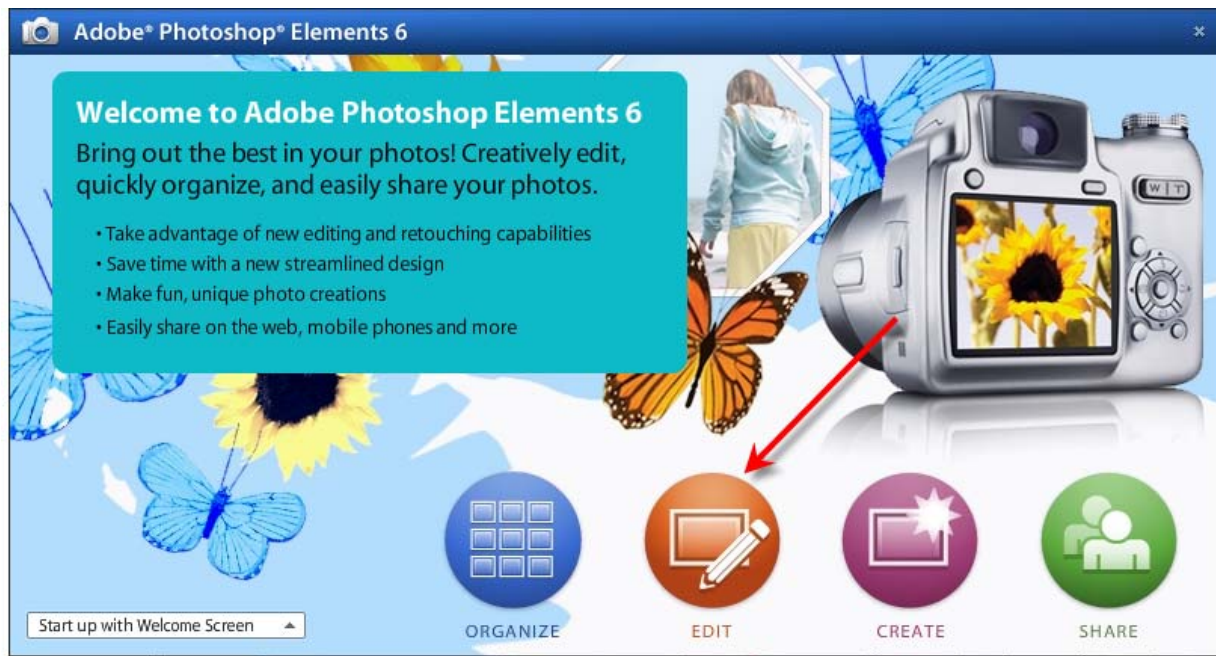

Open the program and choose Edit from the Welcome Screen.

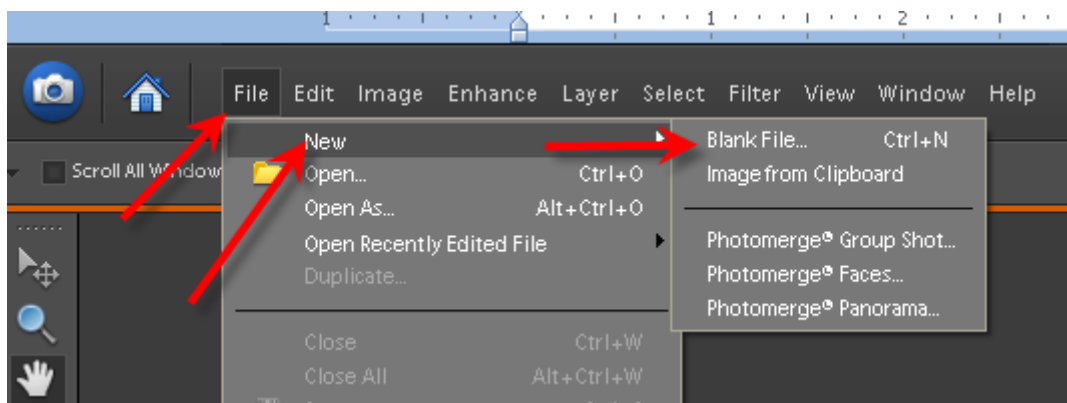

File>New>Blank file

Set size, resolution, background, title as desired (transparent background is best for animations):

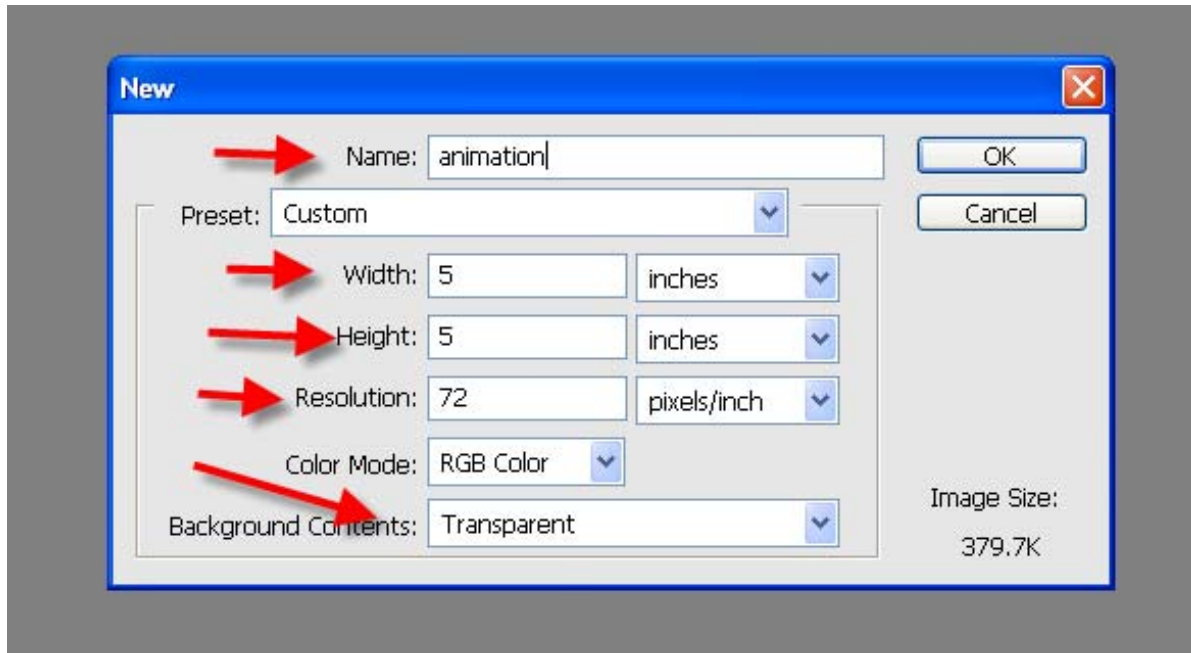

Background will appear in work window – select Custom Shape tool from toolbar along the left side:

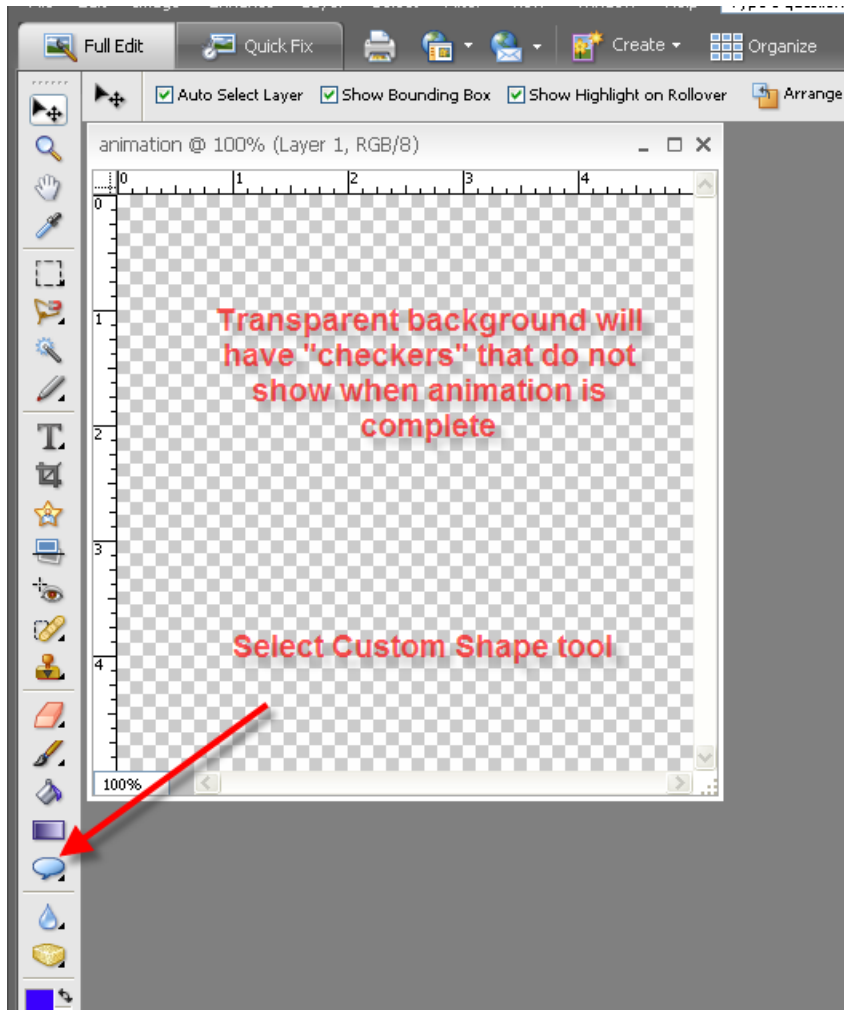

Choose a shape from the window or go to more shapes at pull-down arrow:

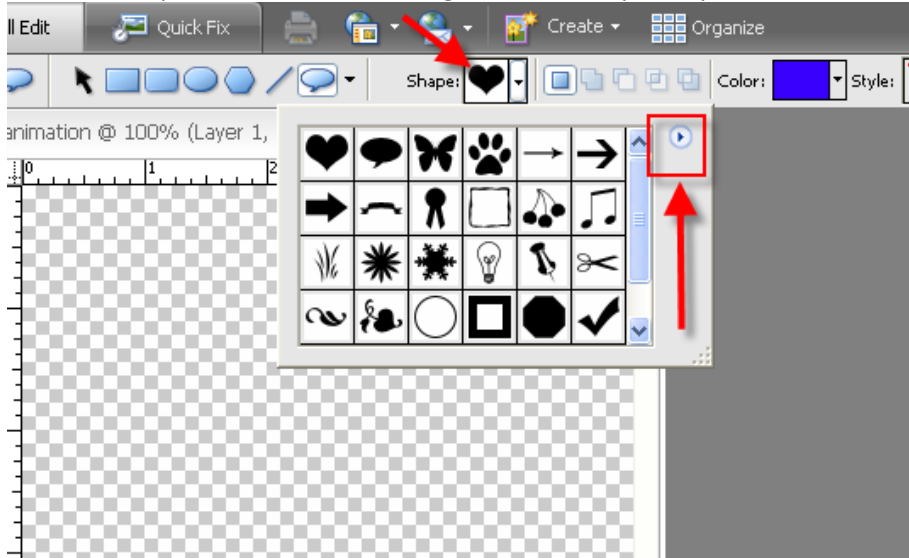

Choose a starting color (click on square):

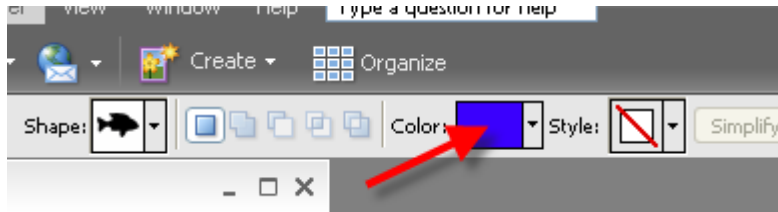

Draw first shape (drag mouse). Hint – holding shift key while drawing will keep proportions:

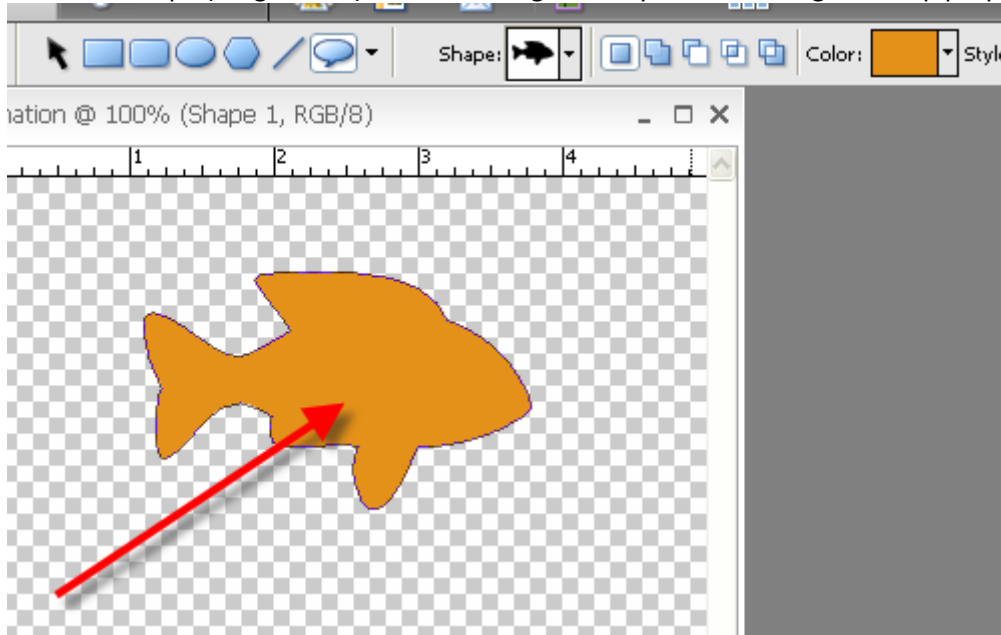

Locate the Layers window :

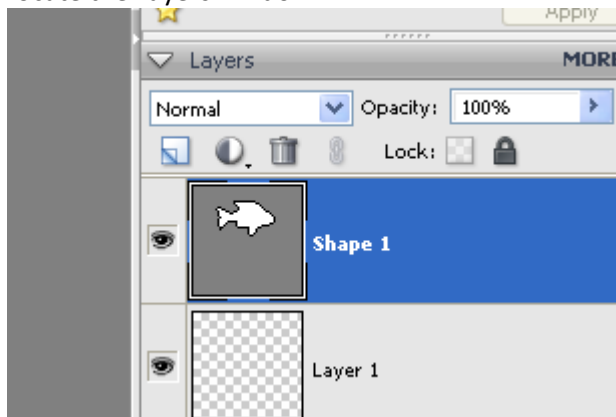

Duplicate the layer:

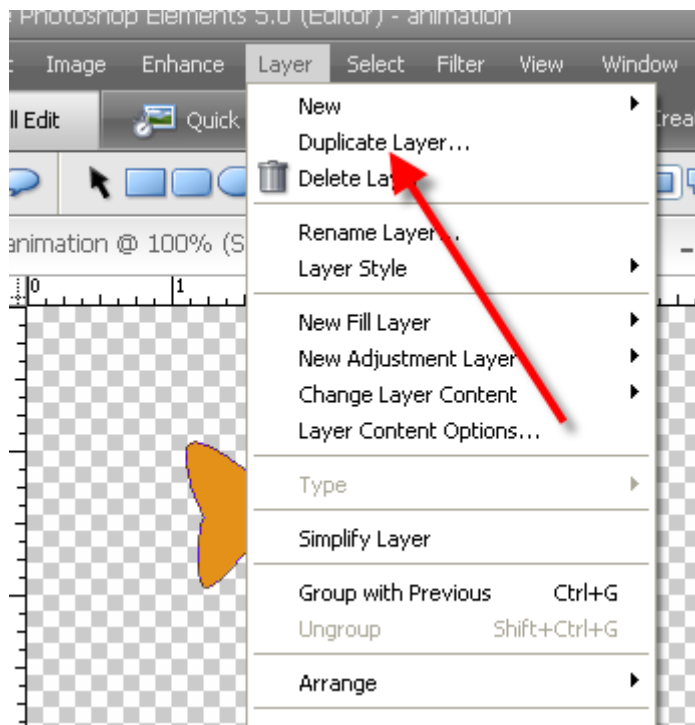

The result:

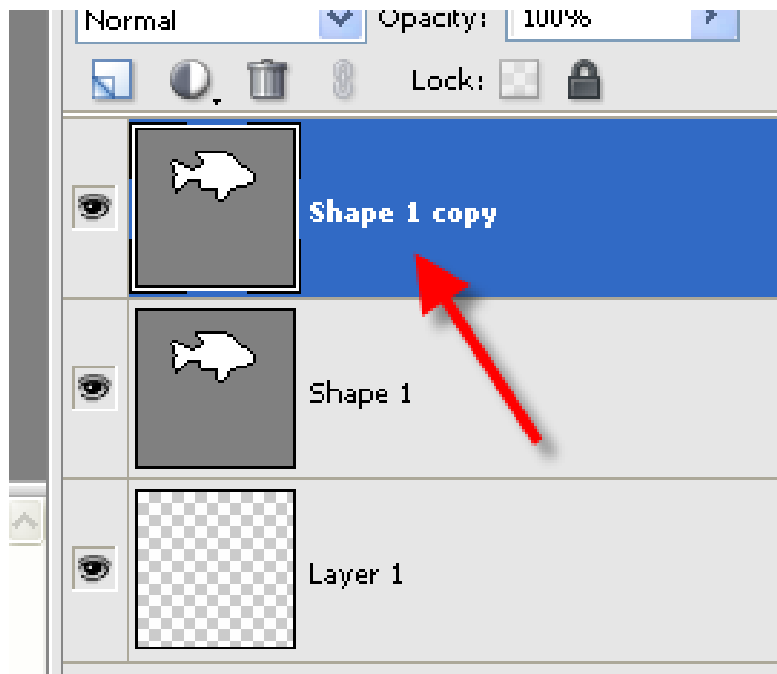

Make sure you are on the new layer, then choose the Move tool at the top of the menu:

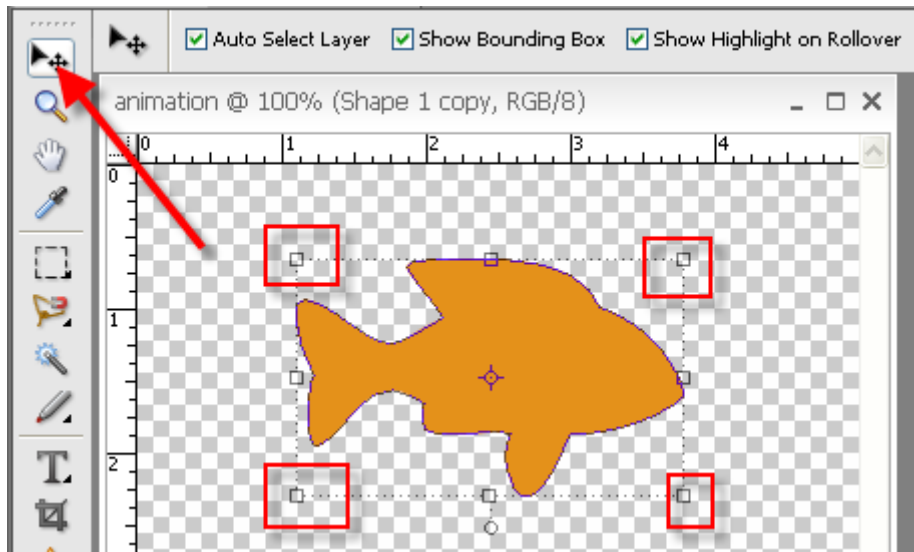

Rotate the shape slightly with the move tool:

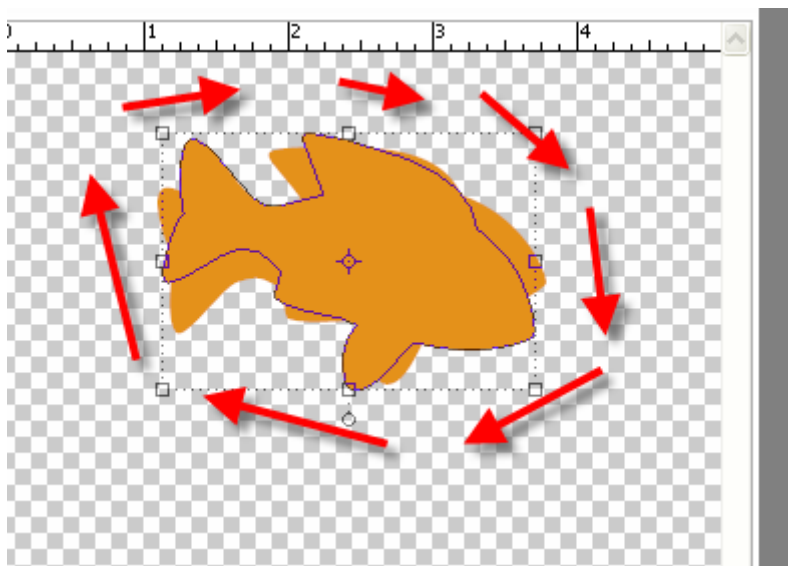

Change the color of the shape by selecting the Custom Shape tool again and going to the color square – choose a slightly lighter or darker color. Hint – the color square will not show up if you have not selected the Custom Shape tool again:

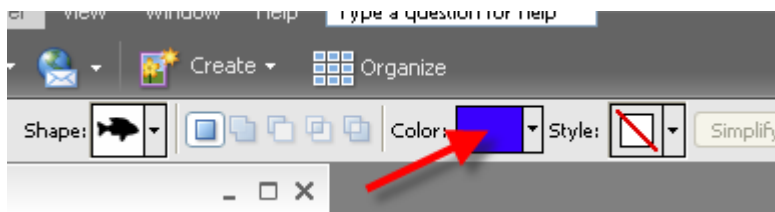

The result:

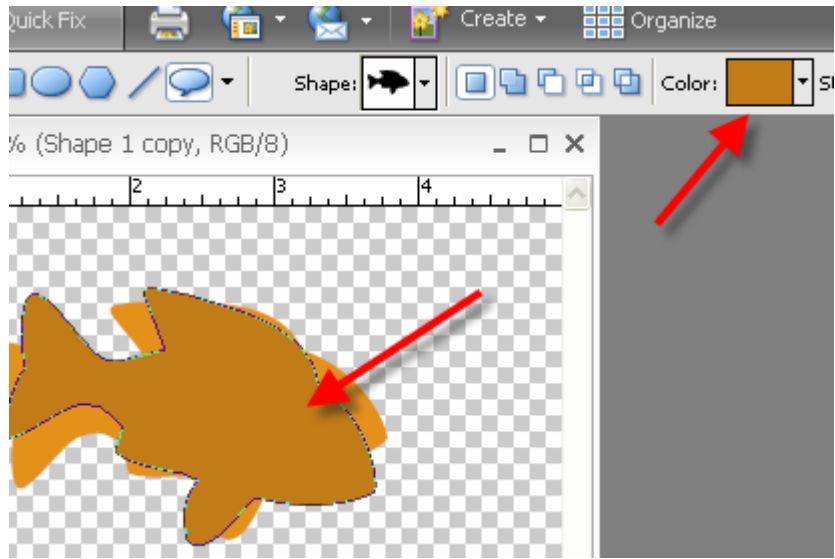

Continue the process:

- **Duplicate layer**
- **Rotate Shape**
- **Change Color**

You should have at least eight layers in your animation:

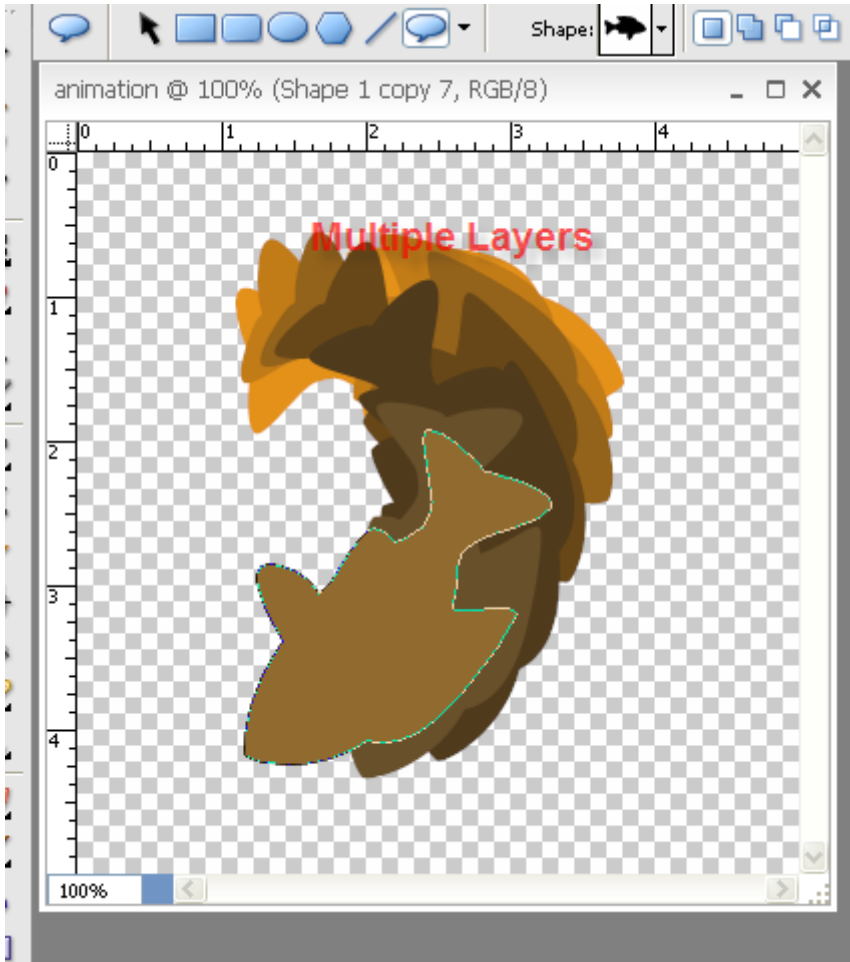

The Layers Window:





Now go to Save for Web:

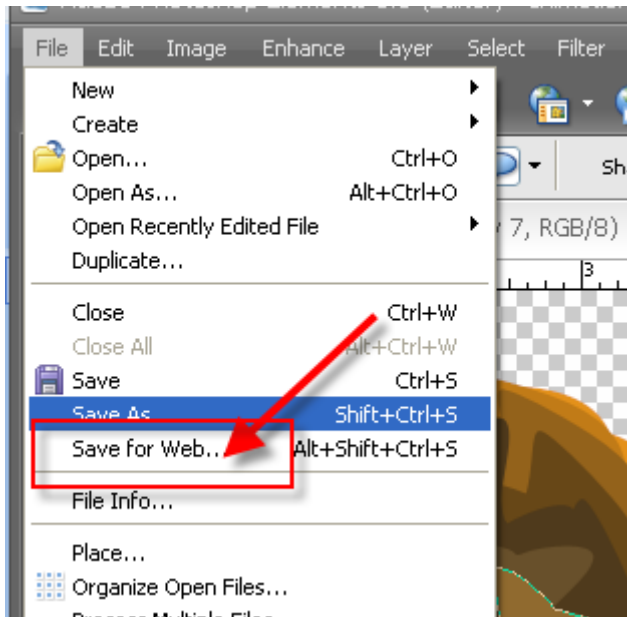

Find the Settings on the Right:

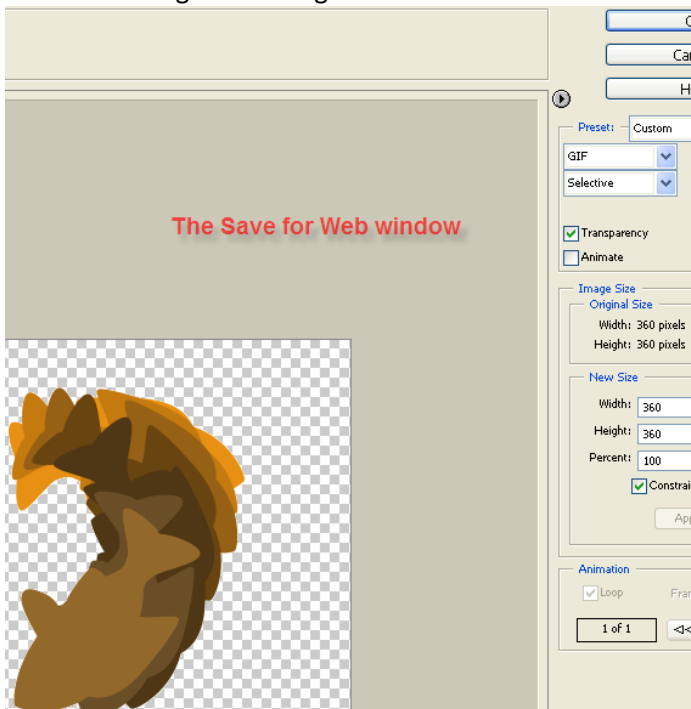

Choose GIF, Animate, Loop and set your frame delay time:

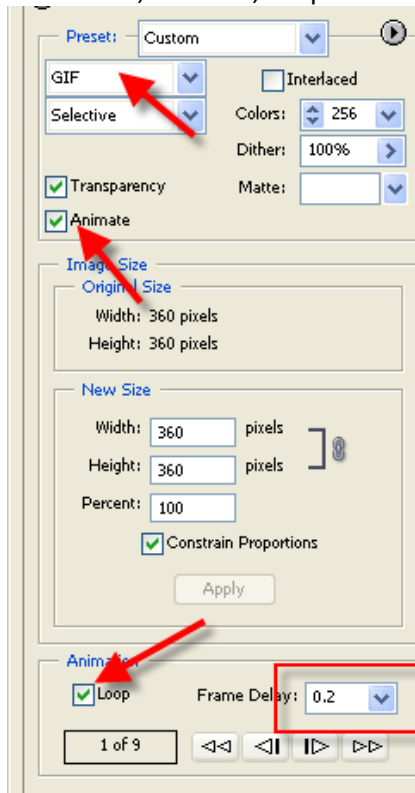

Click on the Preview button at the bottom right:

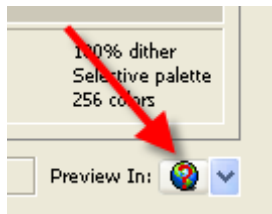

If you like the way it looks, save it in a place that you will remember to use later in a presentation or on the web.



---

mat: GIF  
ensions: 360w x 360h  
: 16.79K  
ins: Selective 256 Colors 100% Diffusion Dither 9 fram